

Features

- Vertical and Horizontal mount
- Flat wire winding on closed magnetic path core
- Smaller winding form factor
- Flat wire dramatically reduces parasitic capacitance
- High magnetic saturation characteristics
- High attenuation to the normal mode noise
- Automatic winding for improved reliability

Applications

- Rated Voltage: AC/DC 250V
- Test Condition: 1KHz 0.25V
- Operating Temperature: -25°C to +120°C
- Storage Temperature: -25°C to +100°C
- Withstanding Voltage: 2.0KVAC 60SEC.

▶ Dimensions & Configurations (Unit:mm)

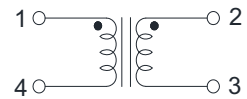
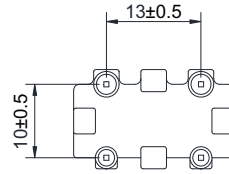
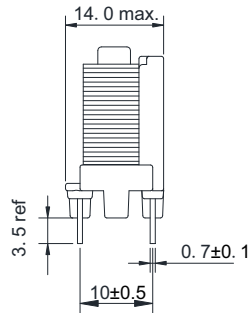
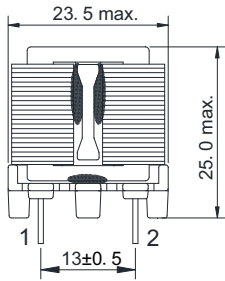

V : Vertical Type

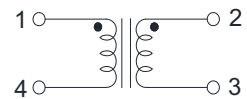
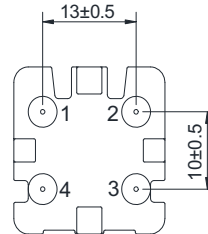
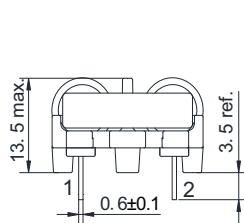
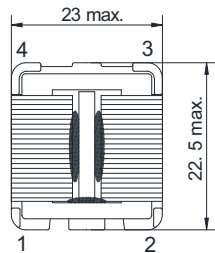

H : Horizontal Type

▶ Electrical Characteristics For SQ1918V / SQ1918H Series

Part Number	Inductance [mH] (Min.)	Rated Current [A] (Max.)	DCR [mΩ] (Max.)
SQ1918V-133U	13	2.5	150
SQ1918V-203U	20	1.5	230
SQ1918V-243U	24	1.0	460
SQ1918H-133U	13	2.5	150
SQ1918H-203U	20	1.5	230
SQ1918H-243U	24	1.0	460