

Material : Nylon 66 UL94V-0, Color Black

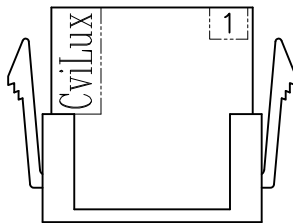

Back View

Circuits	Dimension		
	A	B	C
2	—	3.9(.154)	4.09(.161)
4	3.00(.118)	6.9(.272)	7.09(.279)
6	6.00(.236)	9.9(.390)	10.08(.397)
8	9.00(.354)	12.9(.508)	13.08(.515)
10	12.00(.472)	15.9(.626)	16.06(.633)
12	15.00(.591)	18.9(.744)	19.08(.751)
14	18.00(.709)	21.9(.862)	22.07(.869)
16	21.00(.827)	24.9(.980)	25.07(.967)
18	24.00(.945)	27.9(1.098)	28.07(1.105)
20	27.00(1.063)	30.9(1.217)	31.06(1.223)
22	30.00(1.181)	33.9(1.335)	34.06(1.341)
24	33.00(1.299)	36.9(1.453)	37.06(1.459)

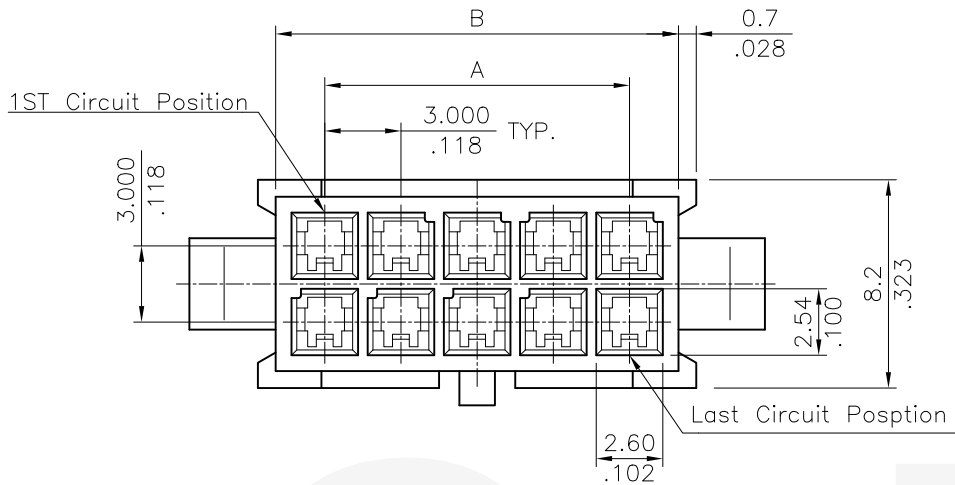
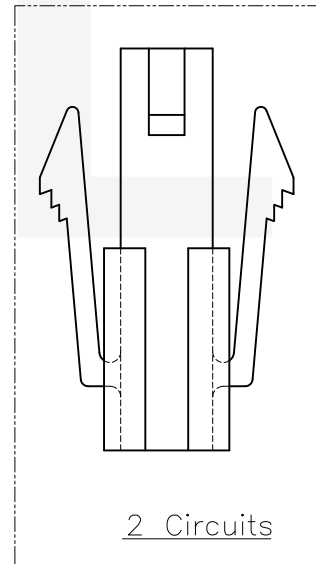
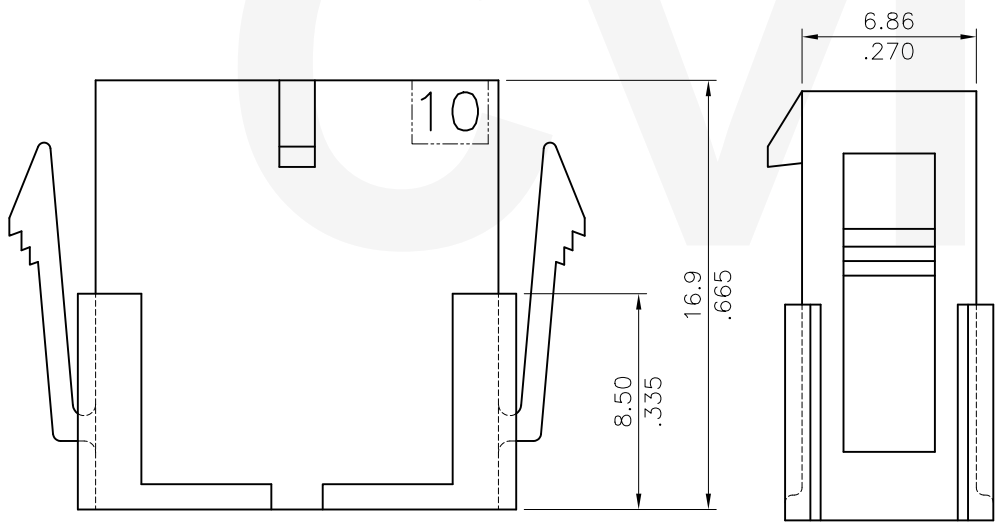

2 Circuits

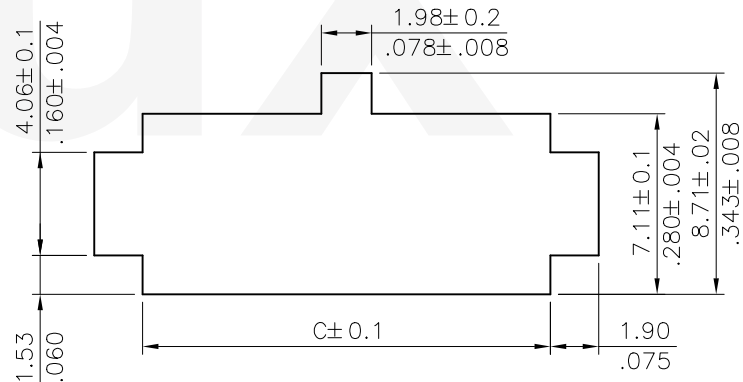

Panel Cutout Size

Halogen-Free RoHS compliant



瀚荃股份有限公司
CviLux Corporation

4					DATE	UNIT: mm / inch	TITLE: 3.00mm PITCH POWER CONNECTOR MALE HOUSING	
3					DRAWN BY: Karen	12/13-16'	TOLERANCE UNLESS OTHERWISE SPECIFIED	MATERIAL:
2					ENGINEER: Sun	12/13-16'	.X ± 0.30 / .012 .X' ± 1"	
1					CHECKED BY: Eisley	12/14-16'	.XX ± 0.20 / .008 .X' ±	FINISH:
SYM	NAME	DATE	REVISIONS		APPROVED BY: Eisley	12/14-16'	.XXX ± 0.10 / .004 .XX ±	

DRAWING NO.	CP35195SA	PART NO.	CP35**P0010-NH
SCALE	3 / 1	SHEET	1 OF 1