



倍仕得电气科技(杭州)股份有限公司
BEISIT ELECTRIC TECH (HANGZHOU) CO.,LTD.



TNP Fluid Connector

TNP流体快速连接器

TNP

流体快速连接器

TNP Fluid Connector



安全环保 Safe & Environmental

- TNP系列产品，采用塑料圆珠锁紧，不损坏被测试件。
- TNP系列产品，可以选择带阀，以满足断开即截止需求。
- 接头均配有保护套，防止在运输中密封面受污染。
- TNP series products, the adoption of plastic ball locking, will not damage the tested parts.
- The TNP series, with optional valving, is available for disconnect-to-shutoff requirements.
- Connector is equipped with protective caps to prevent the sealing surface from being polluted during transportation.

稳定可靠 Stable & Reliable

- 多排圆珠锁紧，保证连接时的锁紧稳定，密封可靠。
- TNP系列产品，本体采用不锈钢材质，推拉环采用铜镀镍材质，使得接头更耐用，又保护被测试件。
- 有多种密封材质O型圈可选，适应不同介质温度需求，保证密封效果长期稳定可靠。
- Multi-row ball locking ensures stable locking and reliable sealing when connecting.
- TNP series products consist of stainless steel bodies and nickel-plated brass sleeves, which provide durability itself and protection for the tested parts.
- A variety of sealing material O-rings are available to meet the temperature requirements of different media and guarantees long term stable & reliable sealing performance.

方便快捷 Convenient

- 圆珠锁紧半自动连接，推入即可锁紧连接并密封，操作轻松，方便快捷。
- 每款TNP产品都可以适配较大的公差范围，提供适配多款测试件的可能性，减少客户换型困扰。
- TNP系列产品可以提供90度转接头，更方便操作。
- 凸肩和滚花的长锁紧环更容易抓握和断开。
- Ball locking semi-automatic connection, push-in to lock the connection and seal, easy to operate, convenient and quick.
- Each TNP product provides a wide range of tolerances, offering the possibility of adapting to a wide range of tested parts and reducing the hassle of changeover for customers.
- The TNP series can be fitted with a 90-degree adapter for easier handling.
- Long locking rings with convex shoulder and knurls for easier gripping and disconnecting.

个性化定制 Customized

- 可定制接头尾端匹配接口，方便安装。
- 定制软管集成，美观，降低泄漏风险。
- 其他定制要求请咨询我司。
- Providing customized end-fitting for easy installation.
- Providing customized hose integration with aesthetic appearance and reducing risk of leakage.
- For other customization requirements, please contact us freely.

TNP**流体快速连接器**

TNP Fluid Connector

**应用领域 Application Fields**

- 三电测试 Military defense, Aerospace and other fields

适用介质 Fluids

- 冷却液 Coolant
- 水-乙二醇 Glycol Water
- 导热油 Heat transfer oils
- 酯类 Esters
- 煤油 kerosene

.....

基础型号 补充选项, 后缀信息
TNP 16V G38F NW- BR - FV - 90

角度 Angle
直通 (默认, 型号不体现)
90 90度弯头
45 135度弯头

密封圈 Sealing
乙丙烯橡胶EPDM (默认, 型号不体现) FF 高氟橡胶FFKM
NB 丁晴橡胶NBR CR 氯丁橡胶CR
FM 氟碳橡胶FPM/FKM/Viton
FV 氟硅橡胶FVMQ

材料 Material
铜+不锈钢304 (默认, 型号不体现)
BR 铜
SA 不锈钢304

接头型号 Connector Size
NW NW型号
SAE SAE型号
MDC MDC型号

内外螺纹 Internal and external threads
F 内螺纹
M 外螺纹

G/R/N/J螺纹尺寸 Size		M螺纹尺寸 Size	
18	1/8	32	1-1/2吋
14	1/4	01	1吋
38	3/8		
12	1/2		
34	3/4		
		08	M8螺纹
		12	M12螺纹
		21	M21螺纹
		H08	接08内径的橡胶软管
		T812	接8x12的塑料管

连接方式 Connection method
G G螺纹
M M螺纹
H 软管Hose
T 扣压塑料管TUBE

是否带阀 Is it equipped with a valve
有V 带阀
无V 无阀

接头型号大小 Connector Size	
04	4mm 14 14mm
06	6mm 16 16mm
08	8mm 20 20mm

类目名称 Category name
T 其他
N 非金属圆珠
P 推拉环

材质 Material	编码 Code	工作温度 Working temperature	应用 Application
丁腈橡胶 NBR	NB	-15 ~ + 100°C	1、一般应用 2、良好的机械强度 1. General applications. 2. High mechanical strength.
氟碳橡胶 FPM、FKM、Viton	FM	-10 ~ + 200°C	1、良好的耐化学性 2、优异的耐高温性能，可用于最高200°C的应用 3、适用于矿物油、合成液压油、燃料、化工产品、碳氢化合物和导热流体回路 1. Good chemical resistance. 2. Outstanding resistance to high temperatures up to 200°C. 3. Resistance to mineral oils, synthetic hydraulic oils, fuels, chemicals, hydrocarbons and coolants.
乙丙橡胶 EPDM	EP	-20 ~ + 150°C	1、优异的耐高温性 2、适用于磷酸盐酯型制动液，冷、热水，蒸汽 3、注意介质回路各部件不能使用含矿物油的情况 1. Excellent resistance to high temperatures. 2. Compatible with phosphate-based brake fluids - esters, hot and cold water, steam. 3. Pay attention to the use of mineral oil in the components of the medium circuit
高氟橡胶 FFKM	FF	0 ~ + 250°C	1、兼具弹性体和聚四氟乙烯耐化学腐蚀性的特点 2、具有很好的耐热性和耐多数化学剂 3、适用于导热流体 1. Combines the qualities of an elastomer with the chemical resistance of PTFE. 2. Remarkable resistance to heat and most chemical agents including inorganic and organic acids. 3. Coolants.
氟硅橡胶 FVMQ	FV	-45 ~ + 175°C	1、最大工作压力：50 bar 2、良好的耐低温和耐高温性能 3、适用于矿物油、燃料 1. Max. working pressure: 50 bar. 2. Good resistance to low and high temperatures. 3. Resistance to mineral oils, fuels.
聚四氟乙烯 PTFE	PT	-50 ~ + 200°C	1、最大工作压力：80 bar 2、良好的耐化学性 3、优异的耐低温和耐高温性能 4、比弹性体的性能更优异 1. Max. working pressure: 80 bar. 2. Excellent chemical resistance. 3. Very good resistance to low and high temperatures. 4. Superior performance to elastomers.
氯丁橡胶 CR	CR	-40 ~ + 100°C	耐老化，特别适用于制冷液 Good resistance to ageing and refrigerants.

为了选择最能满足您应用需求的解决方案，建议向我们提供如下准确信息：

In order to choose the solution that best meets your application needs, it is recommended to provide us with the following accurate information:

- 1、流体类型 2、工作压力 3、工作温度 4、水溶液的盐和酸浓度 5、特别的使用条件
1. Fluid type 2. Work pressure 3. Working temperature 4. Salt and acid concentration of aqueous solution 5. Special usage conditions

若需咨询，请随时联系我们的技术专家。
我们经验丰富的快速连接器专家，为您提供最贴心的服务。
If you need any inquiries, please feel free to contact our technical experts.
Our experienced quick connector experts provide you with the most thoughtful service.

→ TNP 12-NW

插头插座连接图
Plug and socket connection diagram

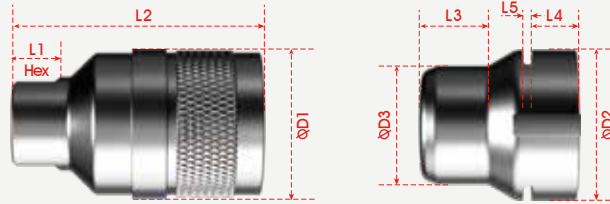

	Picture	End Fitting Type	L1	L2	L3	L4	L5	D1	D2	D3	Hex	Product model
插座		G3/8内螺纹	13	56	/	/	/	34	/	/	22	TNP 12 G38F-NW
插头		/	/	/	14~24	>4	1.8	/	21.5 ^{+0.02} _{-0.02}	16.3 ^{-0.03}	/	NW 12
		/	/	/	14~24	>4	1.8	/	21.5 ^{+0.02} _{-0.02}	16.3 ^{-0.03}	/	NW 12
		/	/	/	14~24	>4	1.8	/	21.5 ^{+0.02} _{-0.02}	16.3 ^{-0.03}	/	NW 12
		/	/	/	14~24	>4	1.8	/	21.5 ^{+0.02} _{-0.02}	16.3 ^{-0.03}	/	NW 12
		/	/	/	14~24	>4	1.8	/	21.5 ^{+0.02} _{-0.02}	16.3 ^{-0.03}	/	NW 12
		/	/	/	14~24	>4	1.8	/	21.5 ^{+0.02} _{-0.02}	16.3 ^{-0.03}	/	NW 12

若需咨询其他尾端连接方式，请随时联系我们的技术专家。
我们经验丰富的快速连接器专家，为您提供最贴心的服务。
If you need to inquire about other end fitting, please feel free to contact our technical experts.
Our experienced quick connector experts provide you with the most thoughtful service.

→ TNP 14-NW

插头插座连接图
Plug and socket connection diagram

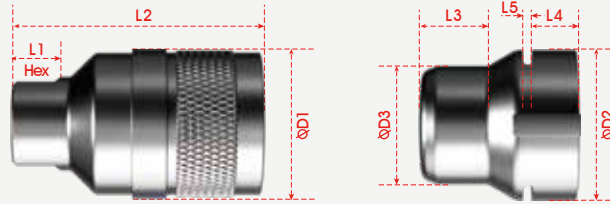

	Picture	End Fitting Type	L1	L2	L3	L4	L5	D1	D2	D3	Hex	Product model
插座		G3/8内螺纹	13	60	/	/	/	37	/	/	22	TNP 14 G38F-NW
插头		/	/	/	14~24	>4	1.8	/	25.0 ^{+0.02} _{-0.02}	20.5 ^{-0.3}	/	NW 14
		/	/	/	14~24	>4	1.8	/	25.0 ^{+0.02} _{-0.02}	20.5 ^{-0.3}	/	NW 14
		/	/	/	14~24	>4	1.8	/	25.0 ^{+0.02} _{-0.02}	20.5 ^{-0.3}	/	NW 14
		/	/	/	14~24	>4	1.8	/	25.0 ^{+0.02} _{-0.02}	20.5 ^{-0.3}	/	NW 14
		/	/	/	14~24	>4	1.8	/	25.0 ^{+0.02} _{-0.02}	20.5 ^{-0.3}	/	NW 14
		/	/	/	14~24	>4	1.8	/	25.0 ^{+0.02} _{-0.02}	20.5 ^{-0.3}	/	NW 14

若需咨询其他尾端连接方式，请随时联系我们的技术专家。
我们经验丰富的快速连接器专家，为您提供最贴心的服务。
If you need to inquire about other end fitting, please feel free to contact our technical experts.
Our experienced quick connector experts provide you with the most thoughtful service.

→ TNP 16-NW

插头插座连接图
Plug and socket connection diagram

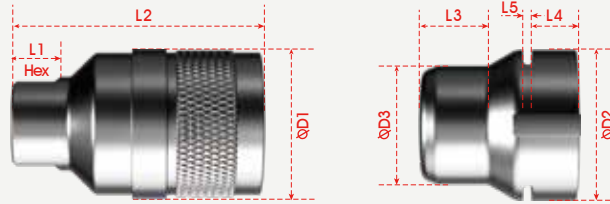

Picture	End Fitting Type	L1	L2	L3	L4	L5	D1	D2	D3	Hex	Product model
插座	G3/8内螺纹	13	65.6	/	/	/	40	/	/	22	TNP 16 G38F-NW
插头	/	/	/	14~24	>4	1.8	/	28.3 ^{+0.02} _{-0.02}	22.3 ^{-0.03}	/	NW 16
	/	/	/	14~24	>4	1.8	/	28.3 ^{+0.02} _{-0.02}	22.3 ^{-0.03}	/	NW 16
	/	/	/	14~24	>4	1.8	/	28.3 ^{+0.02} _{-0.02}	22.3 ^{-0.03}	/	NW 16
	/	/	/	14~24	>4	1.8	/	28.3 ^{+0.02} _{-0.02}	22.3 ^{-0.03}	/	NW 16
	/	/	/	14~24	>4	1.8	/	28.3 ^{+0.02} _{-0.02}	22.3 ^{-0.03}	/	NW 16
	/	/	/	14~24	>4	1.8	/	28.3 ^{+0.02} _{-0.02}	22.3 ^{-0.03}	/	NW 16

若需咨询其他尾端连接方式，请随时联系我们的技术专家。
我们经验丰富的快速连接器专家，为您提供最贴心的服务。
If you need to inquire about other end fitting, please feel free to contact our technical experts.
Our experienced quick connector experts provide you with the most thoughtful service.

→ TNP 16-MDC

插头插座连接图
Plug and socket connection diagram

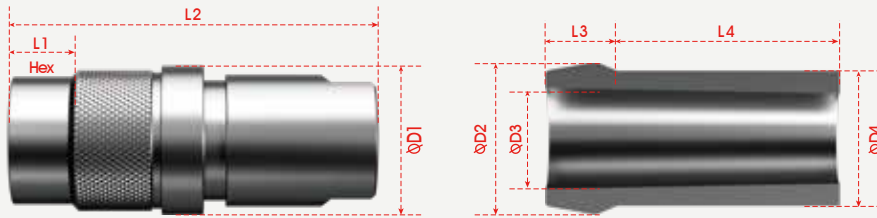

	Picture	End Fitting Type	L1	L2	L3	L4	D1	D2	D3	D4	Hex	Product model
插座		G3/8内螺纹	13	82	/	/	34	/	/	/	24	TNP 16 G38F-MDC
插头		/	/	/	4~9	>16	/	18.1 ⁰ ₋₁₀	13.0 ^{+1.5} _{-1.5}	16.0 ^{+0.15}	/	MDC 16
		/	/	/	4~9	>16	/	18.1 ⁰ ₋₁₀	13.0 ^{+1.5} _{-1.5}	16.0 ^{+0.15}	/	MDC 16
		/	/	/	4~9	>16	/	18.1 ⁰ ₋₁₀	13.0 ^{+1.5} _{-1.5}	16.0 ^{+0.15}	/	MDC 16

若需咨询其他尾端连接方式，请随时联系我们的技术专家。
我们经验丰富的快速连接器专家，为您提供最贴心的服务。
If you need to inquire about other end fitting, please feel free to contact our technical experts.
Our experienced quick connector experts provide you with the most thoughtful service.

→ TNP 20-MDC

插头插座连接图
Plug and socket connection diagram

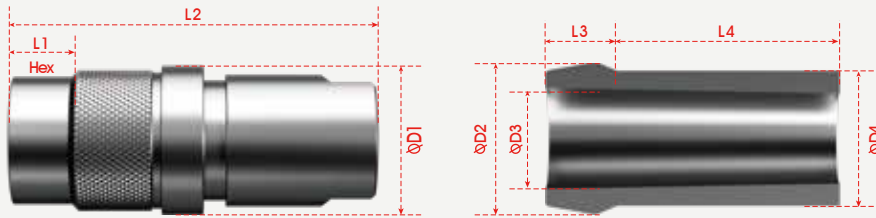

	Picture	End Fitting Type	L1	L2	L3	L4	D1	D2	D3	D4	Hex	Product model
插座		G3/8内螺纹	13	90	/	/	40	/	/	/	24	TNP 20 G38F-MDC
插头		/	/	/	4~9	>16	/	22.4 ⁰ ₋₁₀	16.0 ^{+1.5} _{-1.5}	20.0 ^{+0.15}	/	MDC 20
		/	/	/	4~9	>16	/	22.4 ⁰ ₋₁₀	16.0 ^{+1.5} _{-1.5}	20.0 ^{+0.15}	/	MDC 20
		/	/	/	4~9	>16	/	22.4 ⁰ ₋₁₀	16.0 ^{+1.5} _{-1.5}	20.0 ^{+0.15}	/	MDC 20

若需咨询其他尾端连接方式，请随时联系我们的技术专家。
我们经验丰富的快速连接器专家，为您提供最贴心的服务。
If you need to inquire about other end fitting, please feel free to contact our technical experts.
Our experienced quick connector experts provide you with the most thoughtful service.

→ TNP 06-SAE

插头插座连接图
Plug and socket connection diagram

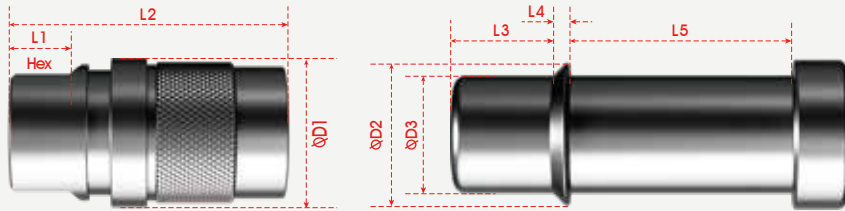

	Picture	End Fitting Type	L1	L2	L3	L4	L5	D1	D2	D3	Hex	Product model
插座		G1/4内螺纹	12	58	/	/	/	26	/	/	24	TNP 06 G14F-SAE
插头		/	/	/	8~33	<3	>8	/	10.1 ^{-0.1}	6.5 ^{+0.1}	/	SAE 06
		/	/	/	8~33	<3	>8	/	10.1 ^{-0.1}	6.5 ^{+0.1}	/	SAE 06

若需咨询其他尾端连接方式，请随时联系我们的技术专家。
我们经验丰富的快速连接器专家，为您提供最贴心的服务。
If you need to inquire about other end fitting, please feel free to contact our technical experts.
Our experienced quick connector experts provide you with the most thoughtful service.

→ TNP 16-SAE

插头插座连接图
Plug and socket connection diagram

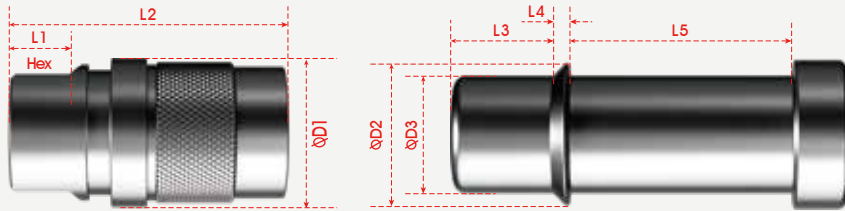

	Picture	End Fitting Type	L1	L2	L3	L4	L5	D1	D2	D3	Hex	Product model
插座		G1/4内螺纹	13	62.1	/	/	/	33	/	/	24	TNP 16 G14F-SAE
插头		/	/	/	13~34	<3.5	>9	/	19.4 ⁰ ₋₁	16.0 ⁰ _{±3}	/	SAE 16
		/	/	/	13~34	<3.5	>9	/	19.4 ⁰ ₋₁	16.0 ⁰ _{±3}	/	SAE 16

若需咨询其他尾端连接方式，请随时联系我们的技术专家。
我们经验丰富的快速连接器专家，为您提供最贴心的服务。
If you need to inquire about other end fitting, please feel free to contact our technical experts.
Our experienced quick connector experts provide you with the most thoughtful service.

→ TNP 16-MDC-SAE

插头插座连接图
Plug and socket connection diagram

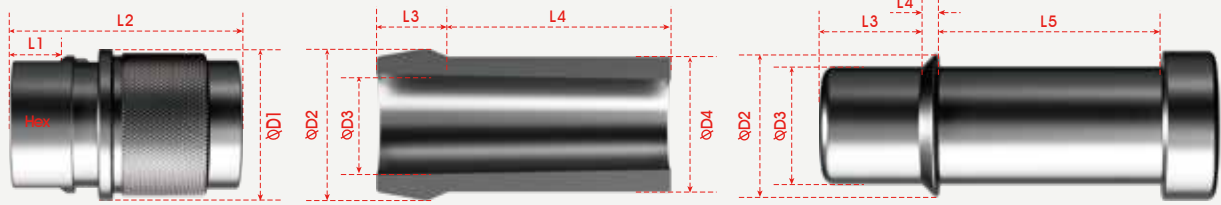

	Picture	End Fitting Type	L1	L2	L3	L4	L5	D1	D2	D3	D4	Hex	Product model
插座		G3/8内螺纹	13	48.5	/	/	/	33	/	/	/	24	TNP 16 G38F- MDC-SAE
插头		/	/	/	8~9	>21	/	/	18.1 ^{+0.10}	/	16.0 ^{+0.15}	/	MDC 16
		/	/	/	>25	<2	>8	/	19.4 ^{+0.10}	16.0 ^{-0.03}	/	/	SAE 16

若需咨询其他尾端连接方式，请随时联系我们的技术专家。
我们经验丰富的快速连接器专家，为您提供最贴心的服务。
If you need to inquire about other end fitting, please feel free to contact our technical experts.
Our experienced quick connector experts provide you with the most thoughtful service.

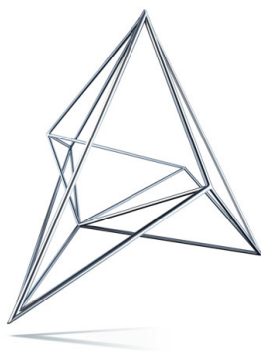

Symmetron

МОСКВА
Ленинградское ш., д. 69, к. 1
Тел.: +7 495 961-20-20
moscow@symmetron.ru

САНКТ-ПЕТЕРБУРГ
ул. Таллинская, д. 7
Тел.: +7 812 449-40-00
spb@symmetron.ru

НОВОСИБИРСК
ул. Блюхера, д. 716
Тел.: +7 383 361-34-24
sibir@symmetron.ru

www.symmetron.ru