

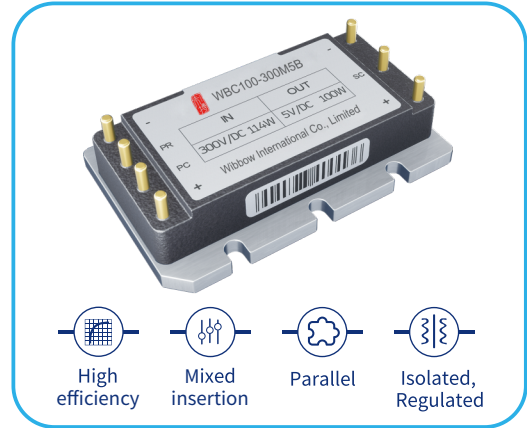

WBC300 Series Quarter Brick power supply

Features

- Isolated, Regulated
- Variable frequency control, mixed insertion with Vicor V300C series
- Input surge resistance: 400V/100ms
- Wide output adjustment range: 75%-110%
- About 5% higher efficiency than similar Vicor products
- Over-voltage, under-voltage, over-current, short-circuit and thermal protections
- Supports 8 parallel expansion (without ORING);
- 3000Vac isolation
- Operating temperature: -55°C~100°C (non-derating)
- Quarter brick standard package: 57.9 x 36.8 x 12.7 mm
- Comply with the General Specification for Microcircuit Modules (SJ20668)



Product specification

Product series	Input voltage range	Output voltage range	Adjustable range	Output current	Output power	Efficiency	Development progress
WBC75-300M3V3B	180~375V	3.3V	75%~110%	22.72A	75W	86%	Available
WBC100-300M5B	180~375V	5V	75%~110%	20A	100W	89%	Available
WBC100-300M8B	180~375V	8V	75%~110%	12.5A	100W	88.5%	Available
WBC150-300M12B	180~375V	12V	75%~110%	12.5A	150W	89.5%	Available
WBC150-300M15B	180~375V	15V	75%~110%	10A	150W	90.7%	Available
WBC150-300M24B	180~375V	24V	75%~110%	6.25A	150W	90.5%	Available
WBC150-300M28B	180~375V	28V	75%~110%	5.36A	150W	90.5%	Available
WBC150-300M36B	180~375V	36V	75%~110%	4.17A	150W	90.5%	Available
WBC150-300M48B	180~375V	48V	75%~110%	3.13A	150W	91%	Available

Shape & Size

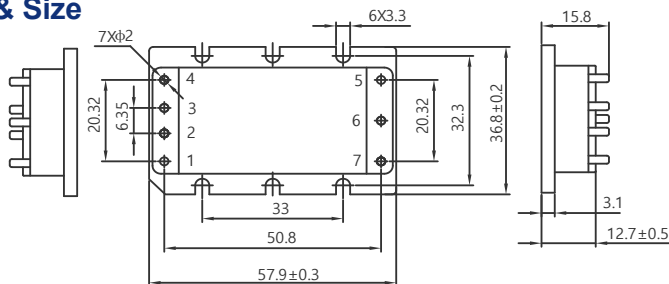

Pin No.	Label	Function
1	+IN	Positive input power terminal
2	PC	Primary side control
3	PR	Parallel terminal
4	-IN	Negative input power terminal
5	-OUT	Negative output power terminal
6	SC	Secondary side control terminal
7	+OUT	Positive output power terminal

Part Numbering

WB	C	75	-	300	M	3V3	B
Brand Name	Package Type	Output power	-	Input voltage range	Temperature Grade	Output voltage range	Version
Wibbow	A: Full-brick B: 1/2 brick C: 1/4 brick	75: 75W 100: 100W 150: 150W		300: 180~375V	M: Tc: -55~100°C Ts: -65~100°C H: Tc: -40~100°C Ts: -55~100°C T: Tc: -40~100°C Ts: -40~100°C	3V3: 3.3V 5: 5V 8: 8V 12: 12V 15: 15V 24: 24V 28: 28V 36: 36V 48: 48V	B: Standard version