

# Power Line Chokes - UT2624 Series

## Current-compensated Frame core double chokes

**Meisongbei**

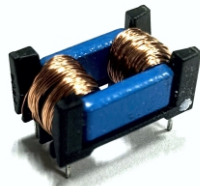

### Features

- High inductance with low DCR
- Low height (14mm)
- High pulse-handling capability
- Very small stray inductance / rated current ratio

### Application

- Suppression of common mode and differential mode interferences
- Electronics ballasts for lamps
- Switch-mode power applications

### General Specifications

- Storage temp range: -40°C to +85°C
- Operating temp range: -40°C to +125°C
- Resistance to Soldering Heat +260°C for 10 Sec.

## ► Dimensions & Configurations (Unit:mm)

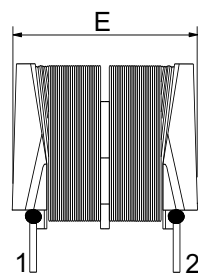
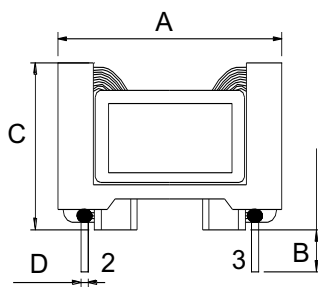

Recommended Layout

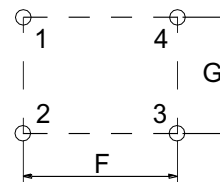

Schematic

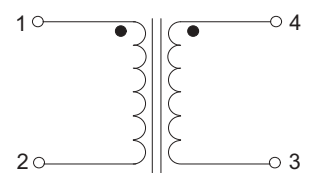

Type	A	B	C	D	E	F	G
UT2624	26.5 max	3.5±0.5	14 max	0.7 ± 0.1	24.8 max	22.5 ± 0.5	20 ± 0.5

## ► Electrical Characteristics For UT2624 Series

Part Number	Inductance [mH] (+50%-30%)	Lstray typ. [uH]	DCR(max) [mΩ]	Rated Current [A] (Max.)
UT2624-103Y	10	210	188	2.30
UT2624-153Y	15	310	279	1.90
UT2624-273Y	27	550	440	1.40
UT2624-393Y	39	800	696	1.20
UT2624-473Y	47	970	804	1.10
UT2624-683Y	68	1440	1100	0.90
UT2624-104Y	100	2100	1810	0.70

- Inductance tested at 10kHz, 0.0Adc
- Rated voltage: 250VAC (50/60Hz)
- Hi-pot: 2000VAC