

# TECHNICAL CHARACTERISTICS

## SPECIFICATION

- >Item No.: 79523231
- >Material: Phosphor Bronze Nickel Plated
- >Rohs Compliant

### PCB MOUNTING LAYOUT

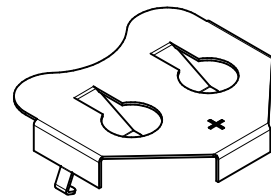
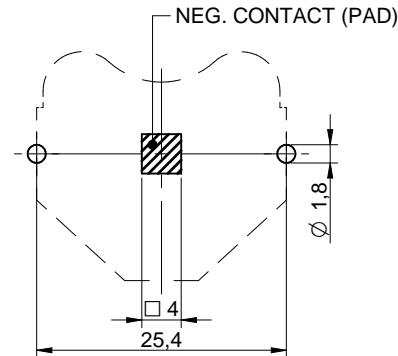
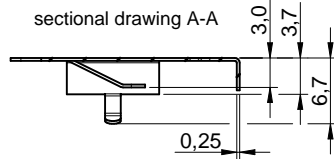
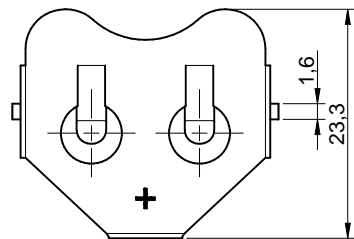
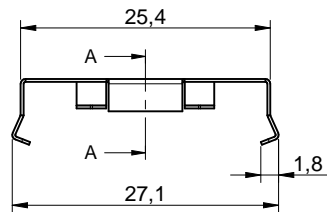
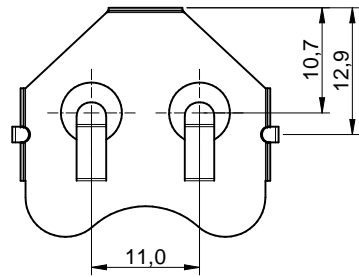

Scale - 1,3:1

				<b>GENERAL TOLERANCE</b> .x = +/- 0,30 .xx = +/- 0,20		Basic material		
				Date	Name	DESCRIPTION		
				Drawn	13-05-27	Fandrey	BattHold	
				Checked	13-05-27	Klingler	Battery Holder	
				Würth Elektronik eiCan		Scale	1,5:1	
						Position		
						Drawing.- No. 79523211		
REV	FILE	DATE	BY	EDV NO	79523211.dft		SIZE A4	
							System Solid Edge V20	