

Feb.1.2020 Copyright 2020 HIROSE ELECTRIC CO., LTD. All Rights Reserved.
In case of consideration for using Automotive equipment / device which demand high reliability, kindly contact our sales window correspondents.

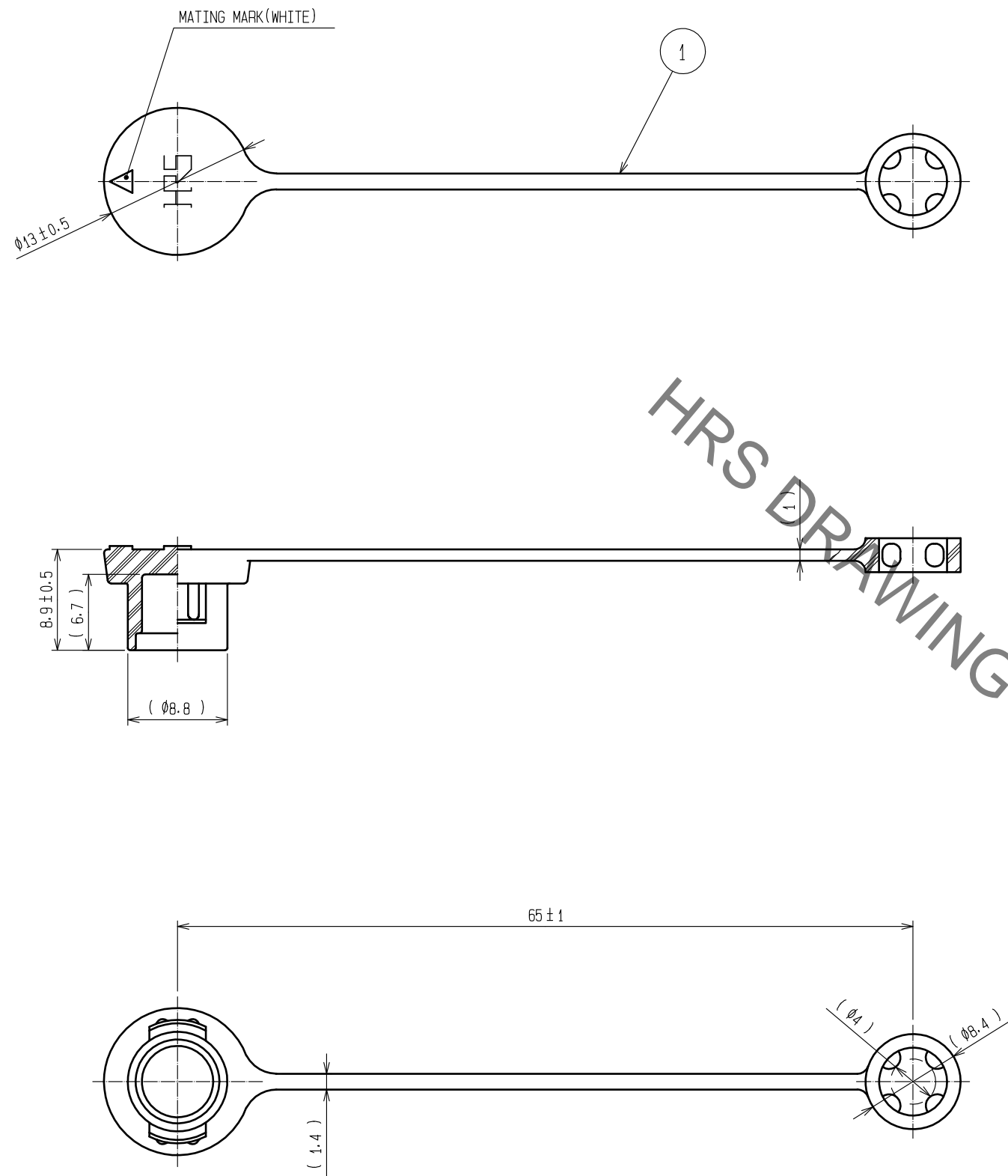

- NOTES
- 1 THIS PART TO BE USED AS ASSEMBLED COMPONENT IN THE DIAGRAM AFTER ASSEMBLING.
 - 2 THIS PRODUCT IS A CAP FOR HR30-6P-※(※).
IT IS APPLICABLE REGARDLESS OF GIVEN ALPHABETS OR NUMBERS SHOWN AT ※.

DIAGRAM AFTER ASSEMBLING

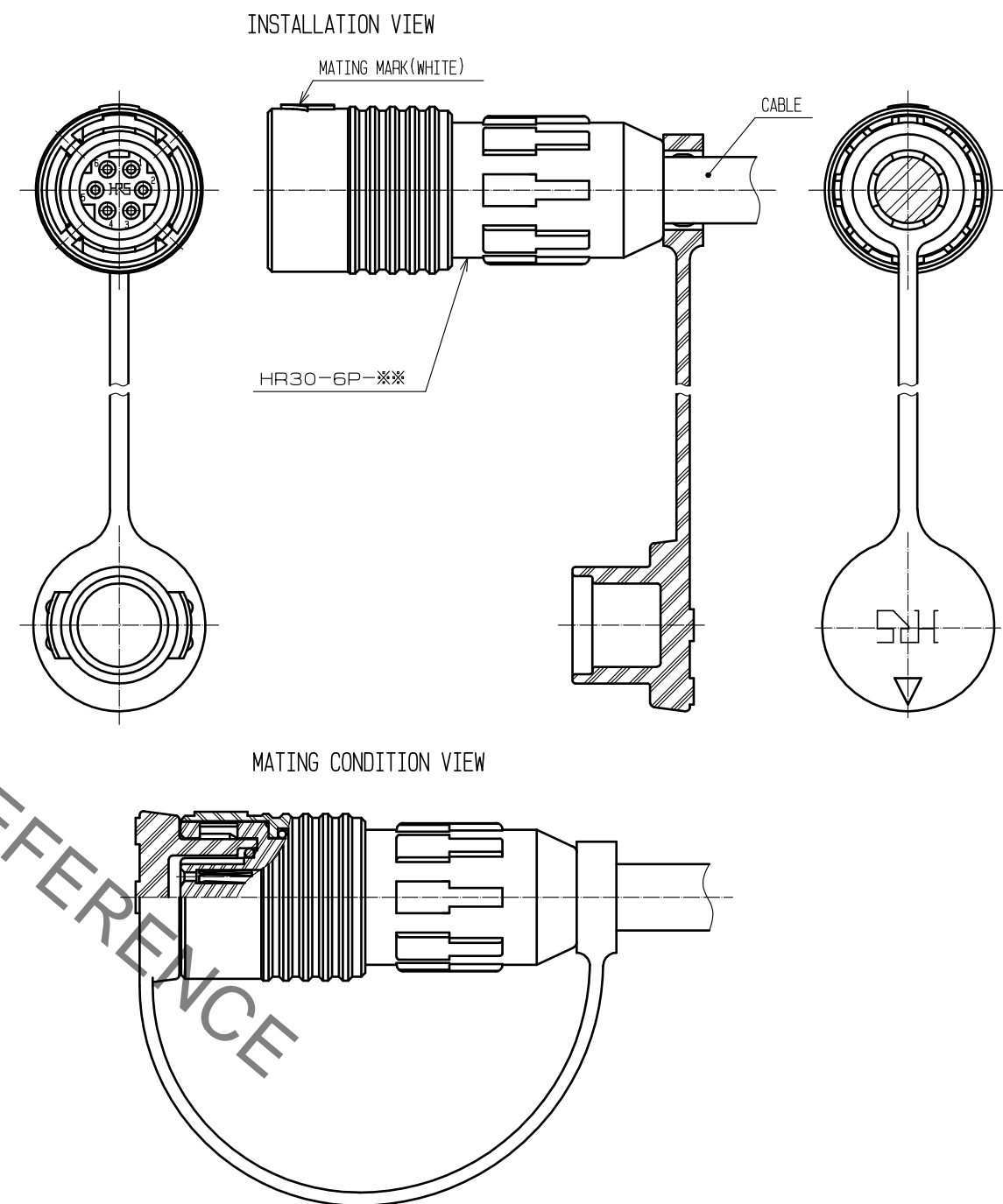

| | | | | | |
|---------------------------|--------------------|------------------|---------------|--------------------------|---------------------------------|
| 1 | CHLOROPRENE RUBBER | BLACK | | | |
| NO. | MATERIAL | FINISH , REMARKS | NO. | MATERIAL | FINISH , REMARKS |
| UNITS mm | | SCALE 2 : 1 | COUNT | DESCRIPTION OF REVISIONS | DESIGNED CHECKED DATE |
| HIROSE ELECTRIC CO., LTD. | | APPROVED | HY. KOBAYASHI | 18. 02. 26 | DRAWING NO. EDC-112273-31-00 |
| | | CHECKED | HY. KOBAYASHI | 18. 02. 26 | PART NO. HR30-6P-C(31) |
| | | DESIGNED | DS. MATSUNE | 18. 02. 24 | CODE NO. CL130-3000-7-31 |
| | | DRAWN | AI. NISHIYAMA | 18. 02. 16 | |