

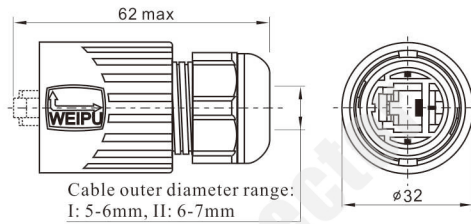

RJ45F plug

P/N: RJ45F6

Cable outer diameter range:
I: 5-6mm, II: 6-7mm



RJ45F Receptacle

P/N: RJ45F71

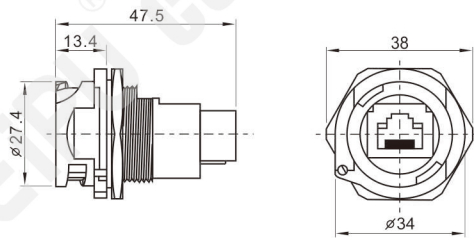

Panel cutout

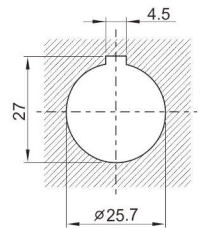

Angled Receptacle

P/N: RJ45F71RA

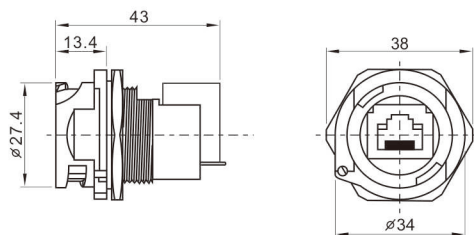

Material and spec

Coupling	Bayonet
Shell material	PC, fire resistance: V-0
IP rating	IP67
Temperature range	-40℃~+85℃