

No.	Name	Description	QTY
①	Antenna element	25*25*4 Ceramics	1
②	Installation method	3MAYÄP	1
③	COVER	50*39*16.9mm ABS+PC BLACK	1
④	CABLE	RG174 CoPPER COAXIAL CABLE 50ohm BLACK	1
⑤	CONNECTOR	SMA-J	1
⑥	H.S TUBE	HEAT SHRINK TUBE	1

MAIN TECHNICAL SPECIFICATIONS	
Model Type	GNSS-SMAJ-5M-5039
Frequency Range	1560-1610MHz
Band Width	10MHz
Axial ratio	≤4DB
Vswr	≤1.8
Gain	28±3DB
Impedance	50 OHM
Polarization	RHCP
Noise Figure	≤ 1.8 DB
DC Voltage	3-5V
DC Current	≤ 25mA
Connector	SMA-J
CABLE	RG174=5000mm
Dielectric Size	50*39*16.9
Working Temp	- 40 ° -- 85°
Way To Install	3M

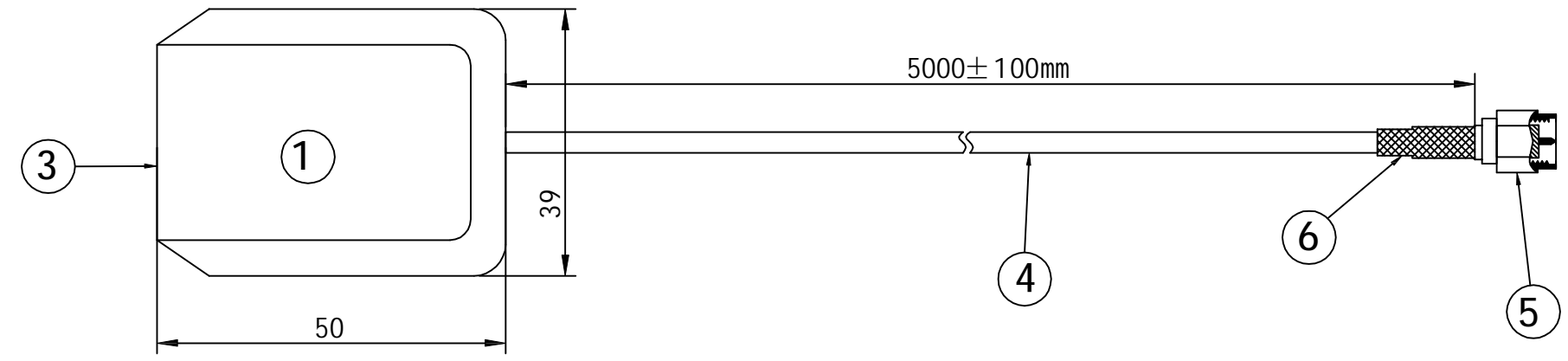
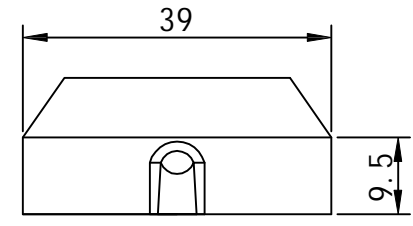
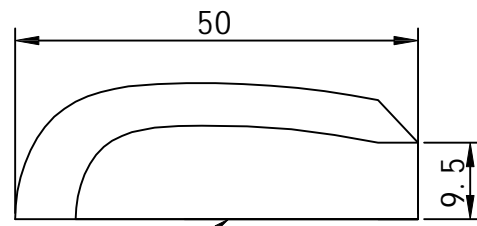

ALL DIMENSIONS ARE IN MILLIMETERS AND [INCHES] Unit:mm

THIRD ANGLE PROJECTION 	PART NAME	GNSS SMA MALE ANTENNA
	DRAWN BY	R.YU
TOLERANCE UNLESS OTHERWISE SPECIFIED .x ±0.25 .xx ±0.20	CHECKED BY	JOSON
	APPROVED BY	
UNIT mm	SCALE free	
REV.	A	
DATE 2023-9-12		
		PART NO. GNSS-SMAJ-5M-5039
		CUSTOMER P/N

ROHO COMMUNICATION TECHNOLOGY CO.,LTD