

专注熔断器研发制造  
Focus on Fuse Development And Production



## 熔断器选型手册 Product Selection Guide

通信行业、电力行业、电动汽车、轨道交通、光伏风能  
充电桩设备、储能设备、等其他熔断器，保护用产品

**浙江弗而兹电气科技有限公司**  
ZHEJIANG FUERZI(FRSI)ELECTRIC TECHNOLOGY CO.,LTD.

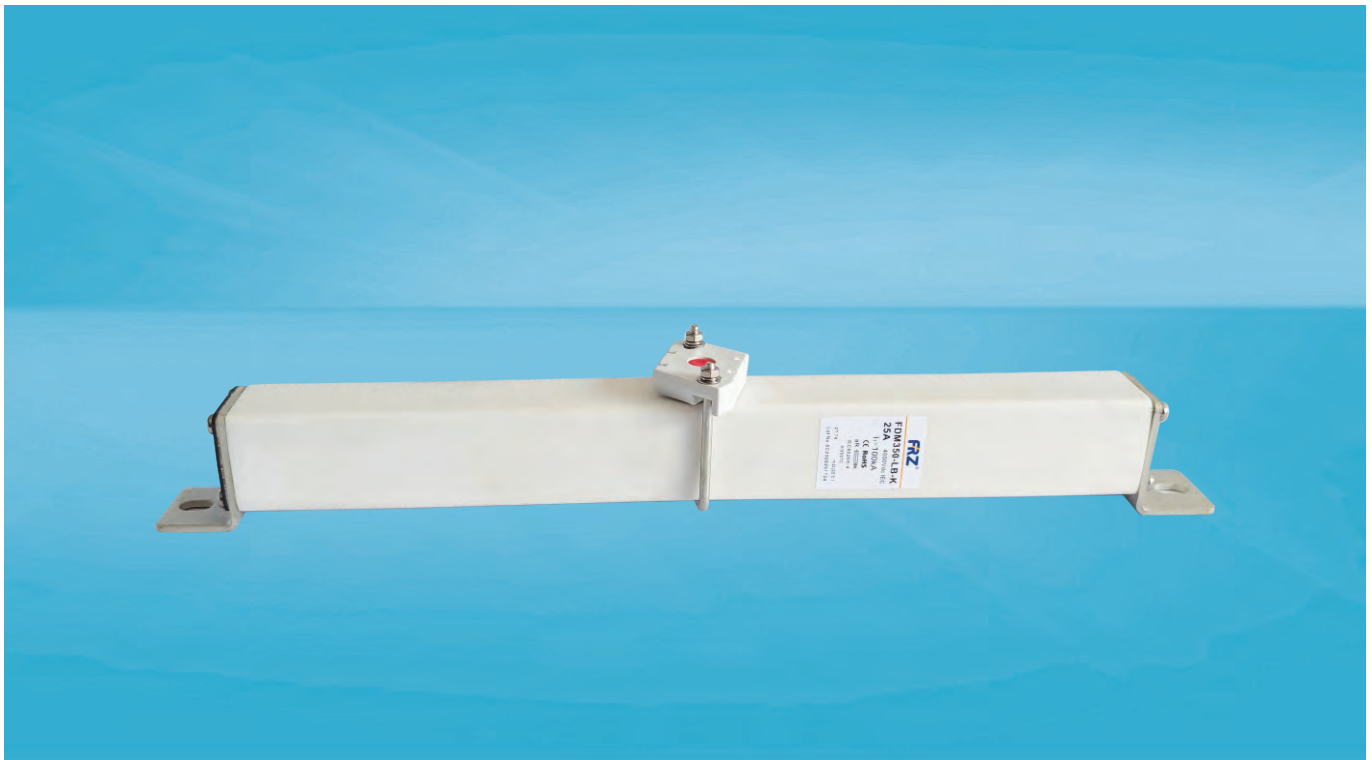

**铁路保护用熔断器**  
Fuse for Railway Transport Protection

### 概述 Overview

- 符合GB/T 13539.4、IEC60269-4标准
- 额定电压：DC4000V
- 更高直流电压请于公司技术部门联系
- 功能等级：aR
- 额定分断能力：50kA/100kA
- 功耗及I2t数据可向技术部门索取
- 重量及装箱数可向公司市场部索取
- It meets GB/T 13539.4、IEC60269-4 standards
- Rated voltage: DC4000V
- For higher DC voltage, please contact the Technical Department
- Functional Level: aR
- Rated breaking capacity: 50kA/100kA
- Power consumption and I2t data can be obtained from the Technical Department.
- The weight and packing information can be obtained from the Marketing Department.

### 工作环境 Working Environment

- 环境温度：环境温度不超过40℃，24h测得的平均值不超过35℃，一年内测得的平均低于该值；周围空气温度最低值为-5℃。
  - 大气条件：空气是干净的，其相对湿度在最高温度为40℃时不超过50%。在较低温度下可以有较高的相对湿度。例如，在20℃时，相对湿度可达90%。由于温度变化发生在产品本体上的凝露情况必须采取措施。
  - 污染等级：3级
  - 安装条件：熔断器应安装在无显著摇动和冲击，无足以腐蚀金属和破坏绝缘得气体及导电尘埃的场所中。
- 注：当熔断器使用条件和规定不相符时，用户应与我公司协商。

⊙ Ambient temperature: ambient temperature does not exceed 40°C and the average value measured in 24 hours does not exceed 35°C and the average value measured in one year is lower than that; the minimum ambient air temperature is - 5 °C.

⊙ Atmospheric Conditions: The air is clean, and its relative humidity does not exceed 50% at the highest temperature of 40°C. The relative humidity can be higher at lower temperatures. For example, the relative humidity can reach 90% at 20°C. Because the temperature change occurs in the condensation of the product body, measures must be taken.

⊙ Pollution Level: Level 3

⊙ Installation Conditions: Fuses shall be installed in places where there is no significant shaking and impact, and where there is no enough corrosion of metals and destruction of insulated gases and conductive dust.

Note: Users should consult with our company when the fuse operating conditions and regulations do not meet requirements.

**FDM系列快速熔断器**  
FDM Series High Speed Fuse

型号 Model	额定电压(V) Rated voltage	额定电流(A) Rated current	尺寸Dimension(mm)										
			A	B	C	D	E	F	G	H	I	N	J
FDM350-LB-K	DC4000	10~100	414	365	max 57	41±1.5	37±1.5	51	70	15	13	9	3

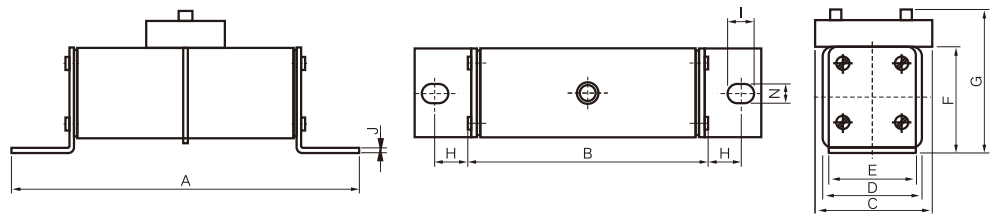

型号 Model	额定电压(V) Rated voltage	额定电流(A) Rated current	尺寸Dimension(mm)								
			A	B	C	D	E	F	G	H	I
FDM352-LB-K	DC4000	150~250	414±3	365±3	65±2.5	89±3	60±2	28±1	9±1	13±1	3±0.2
FDM352-2LB-K	DC4000	315~450	414±3	365±3	65±2.5	161±3	60±2	28±1	9±1	13±1	6±0.2

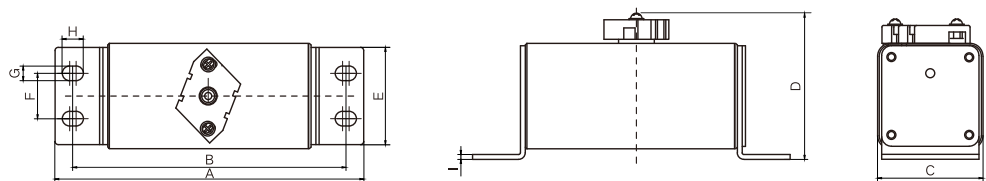

FDM352-LB-K

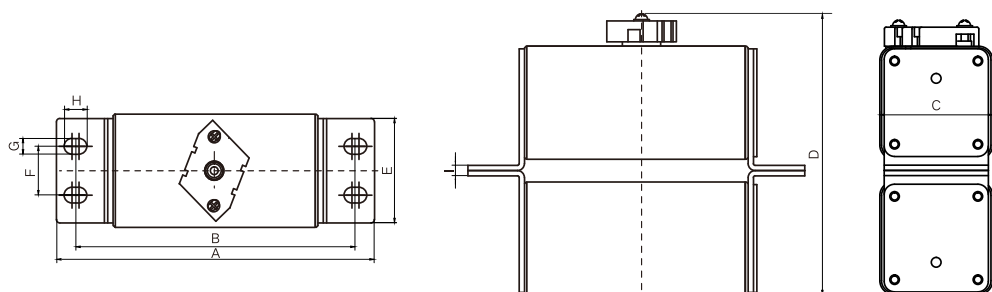

FDM352-2LB-K

本目录刊载的型号和规格会因产品更新而变化，恕不另行通知。  
本目录中的产品外型、技术说明可能与实际有所不同，请以产品实物和使用说明书为准。  
产品种类繁多，详情请咨询我公司或经销商。

Models and specifications in this catalog are subject to change without prior notice.  
The product appearance and technical description in this catalogue may be different from the actual situation, please refer to the product and operation instruction.  
There are many kinds of products, please consult our company or distributor for details.

**FRZ<sup>®</sup> 弗而兹电气**

地址：浙江省乐清市北白象镇东大街512号

电话：0577-6198 6868      传真：0577-6198 6869

官网：<http://www.frsidq.com>      [www.frsielectric.com](http://www.frsielectric.com)

Address: NO.512 Dongda St., Beibaixiang, Yueqing, China

Tel: 0577-6198 6868      Fax: 0577-6198 6869

website: <http://www.frsidq.com>      [www.frsielectric.com](http://www.frsielectric.com)



欢迎关注官方微信公众号