

Ordering Code:

CP35 TN* * P EP
 ① ② ③ ④ ⑤

- ① Series No.
- ② Accept wire gage:
 TN1= AWG #26 ~ #30
 TN2= AWG #20 ~ #24
- ③ Plating code:
 1= Tin plated over Nickel
 A= Selective Gold flash plated over 50μ" Nickel
 B= Selective 15μ" Gold plated over 50μ" Nickel
 C= Selective 30μ" Gold plated over 50μ" Nickel
- ⚠ ④ Material : P= Phosphor Bronze
- ⑤ Style: EP= Plug terminal

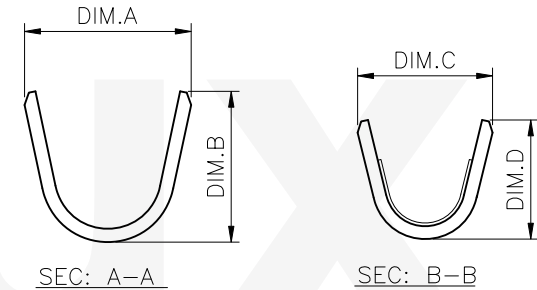
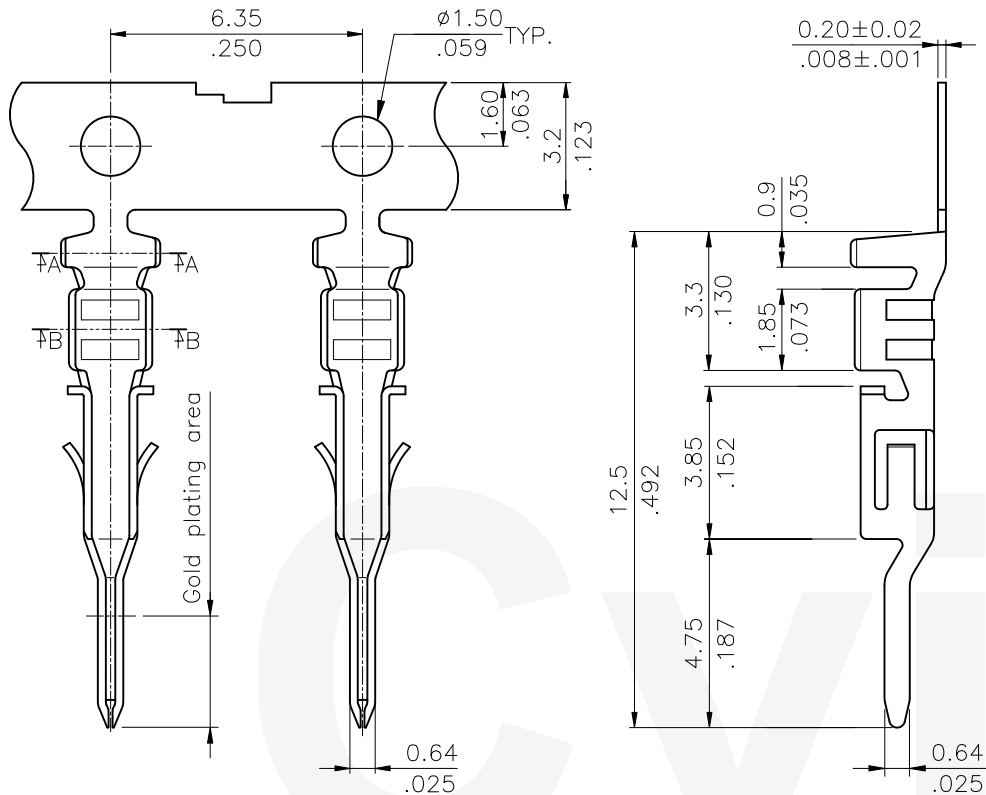

△	P/N	Wire Gauge	Insulation Diameter	Finish	Reel Q'TY
	CP35TN11PEP	AWG#26~#30	1.35 (.053) MAX.	2.03μm (80μinch) Min. Tin plated over	12,000 PCS
	CP35TN21PEP	AWG#20~#24	1.85 (.073) MAX.	0.76μm (30μinch) Nickel	
	CP35TN1APEP	AWG#26~#30	1.35 (.053) MAX.	Selective gold flash on surface contact area	
	CP35TN2APEP	AWG#20~#24	1.85 (.073) MAX.	over 1.27μm (50μinch) Nickel	
	CP35TN1BPEP	AWG#26~#30	1.35 (.053) MAX.	Selective 0.38μm (15μinch) gold on surface	
	CP35TN2BPEP	AWG#20~#24	1.85 (.073) MAX.	contact area over 1.27μm (50μinch) Nickel	
	CP35TN1CPEP	AWG#26~#30	1.35 (.053) MAX.	Selective 0.76μm (30μinch) gold on surface	
	CP35TN2CPEP	AWG#20~#24	1.85 (.073) MAX.	contact area over 1.27μm (50μinch) Nickel	

P/N	DIM.A	DIM.B	DIM.C	DIM.D
CP35TN1*PEP	2.1 (.083)	1.9 (.075)	1.7 (.067)	1.5 (.059)
CP35TN2*PEP	2.5 (.098)	2.4 (.094)	2.1 (.083)	2.0 (.079)

CIVILUX CORP
2018.08.23
ISSUED

RoHS Compliant

△5	Sandy	8/6-18'	ECNT118180		DATE	UNIT: mm / inch	TITLE:	瀚荃股份有限公司 CviLux Corporation
△4	Sun	6/23-16'	ECRB116035/ECNT116136	DRAWN BY: Sandy	8/7-18'	TOLERANCE UNLESS OTHERWISE SPECIFIED	CP35 MALE CRIMP TERMINAL	
△3	Enya	11/07-13'	ECNT113108/ECNT113091/ECRT113022	ENGINEER: Sun	8/15-18'	.X ±0.20/.008 X' ± 1'	MATERIAL:	
△2	Sandy	3/17-08'	ECN08140	CHECKED BY: Eisley	8/16-18'	.XX ±0.10/.004 X' ±	FINISH:	
SYM	NAME	DATE	REVISIONS	APPROVED BY: Eisley	8/16-18'	.XXX ±0.05/.002 .XX' ±		
DRAWING NO. CP3504SJ PART NO. CP35TN**PEP								SCALE 5 / 1 SHEET 1 OF 1