

K92 TYPE -40°C +105°C 8000H

RoHS Compliant

- Design optimized for low equivalent series resistance and high ripple current.
- Surge-proof capacitor in aluminium can with insulation sleeve.
- To be mounted with ring clips or with threaded stud.

APPLICATIONS

Designed for professional application.
Switch mode power suppliers, high ripple current converters, motor drives.

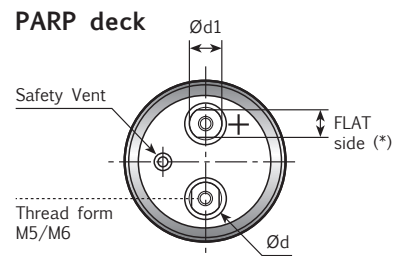
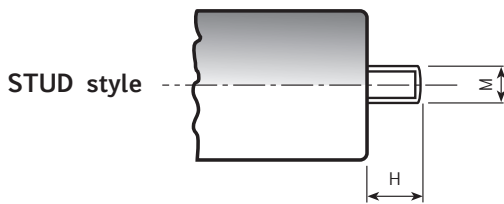
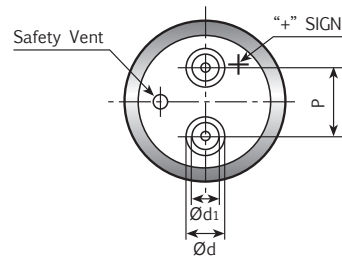
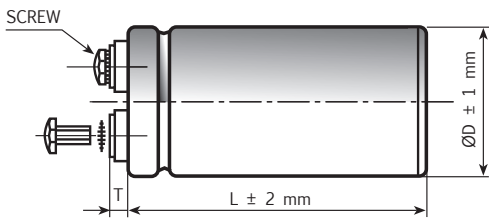

Diagram of dimensions (unit=mm) - Insert and screw threads: Metric (mm), UNF (inches)

ØD	d ±0.3	d1 ±0.3	P ±0.5	T ±2.0	STUD		INSERT	SCREW	INSERT STYLE CODE
					M	H			
35	11.6	7.9	12.7	6.5	M8	12	M5	5MA x 9.5	0
51	18.2	13	22.2	5	M12	16	M5	5MA x 9.5	H
63	18.2	13	28.5	5	M12	16	M5	5MA x 9.5	H
76	18.2	13	31.8	4.5	M12	16	M5	5MA x 9.5	H
76	18.2	13	31.8	6.5	M12	16	M5 long	5MA x 9.5	L
76	23.2	17.7	31.8	5	M12	16	M6	6MA x 10	6
90	23.2	17.7	31.8	5	M12	16	M6	6MA x 10	H
51	13	13(10)*	22.2	5	M12	16	PARP M5	5MA x 9.5	K
63	13	13(10)*	28.5	5	M12	16	PARP M5	5MA x 9.5	B
63	19	15(13)*	28.5	6	M12	16	PARP M5	5MA x 9.5	K
76	19	15(13)*	31.8	6	M12	16	PARP M5	5MA x 9.5	K
76	19	15(13)*	31.8	6	M12	16	PARP M6	6MA x 10	Q
90	19	15(13)*	31.8	6	M12	16	PARP M6	6MA x 10	Q
35	11.6	7.9	12.7	6.5	M12	16	UNF 10-32 High Post	10-32 x 3/8"	U
63	17.3	17.3	28.5	2.5	M12	16	UNF 1/4-28 Low Post	1/4-28 x 3/8"	W
63	17.3	17.3	28.5	6	M12	16	UNF 1/4-28 High Post	1/4-28 x 1/2"	R
63	7.9	7.9	28.5	2	M12	16	UNF 10-32 Low Post	10-32 x 1/4"	Z
63	12	7.9	28.5	6.5	M12	16	UNF 10-32 High Post	10-32 x 3/8"	U
76	17.3	17.3	31.8	2.5	M12	16	UNF 1/4-28 Low Post	1/4-28 x 3/8"	W
76	17.3	17.3	31.8	6	M12	16	UNF 1/4-28 High Post	1/4-28 x 1/2"	R
76	7.9	7.9	31.8	2	M12	16	UNF 10-32 Low Post	10-32 x 1/4"	Z
76	12	7.9	31.8	6.5	M12	16	UNF 10-32 High Post	10-32 x 3/8"	U

Note: (*) quote on the PARP deck of the flat side (PARP = Protection Against Reverse Polarity).

K92 TYPE SPECIFICATIONS

Temperature Range	Operating : -40°C +105°C [Environmental classification 40/105/56 IEC-68] Storage : Preferably below +25°C, not exceeding +40°C																																											
Rated Voltage Range (V_r)	from 400V to 500V DC																																											
Surge Voltage (V_p)	V _p = 1.10 V _r																																											
Rated Capacitance Range	from 470 µF to 10000 µF																																											
Capacitance Tolerance	±20% at 100 Hz, 20°C [M class IEC-62] on request : -10% +30% at 100 Hz, 20°C [Q class IEC-62]																																											
Leakage Current (I_L) (mA, 5 min, 20°C)	max I _L = 0.006 C _r V _r + 4 µA																																											
Ripple current (I_r)	<p>Refer to table at 105°C and 100Hz :</p> <table border="1"> <thead> <tr> <th>FREQUENCY</th> <th>50Hz</th> <th>100Hz</th> <th>500Hz</th> <th>1000Hz</th> <th>>10kHz</th> </tr> </thead> <tbody> <tr> <td>MULTIPLIER</td> <td>0.8</td> <td>1.0</td> <td>1.2</td> <td>1.3</td> <td>1.5</td> </tr> </tbody> </table> <table border="1"> <thead> <tr> <th>AMBIENT TEMP</th> <th>35°C</th> <th>45°C</th> <th>55°C</th> <th>65°C</th> <th>75°C</th> <th>85°C</th> <th>95°C</th> <th>105°C</th> <th>110°C</th> </tr> </thead> <tbody> <tr> <td>MULTIPLIER</td> <td>3.0</td> <td>2.8</td> <td>2.6</td> <td>2.4</td> <td>2.2</td> <td>1.8</td> <td>1.5</td> <td>1.0</td> <td>0.5</td> </tr> </tbody> </table> <p>Due to the current load capability of the contact elements, the following limits must not be exceeded:</p> <table border="1"> <thead> <tr> <th>CAPACITOR DIAMETER</th> <th>51mm</th> <th>63mm</th> <th>76mm</th> <th>90mm</th> </tr> </thead> <tbody> <tr> <td>Maximum current</td> <td>30A</td> <td>40A</td> <td>50A</td> <td>70A</td> </tr> </tbody> </table>		FREQUENCY	50Hz	100Hz	500Hz	1000Hz	>10kHz	MULTIPLIER	0.8	1.0	1.2	1.3	1.5	AMBIENT TEMP	35°C	45°C	55°C	65°C	75°C	85°C	95°C	105°C	110°C	MULTIPLIER	3.0	2.8	2.6	2.4	2.2	1.8	1.5	1.0	0.5	CAPACITOR DIAMETER	51mm	63mm	76mm	90mm	Maximum current	30A	40A	50A	70A
FREQUENCY	50Hz	100Hz	500Hz	1000Hz	>10kHz																																							
MULTIPLIER	0.8	1.0	1.2	1.3	1.5																																							
AMBIENT TEMP	35°C	45°C	55°C	65°C	75°C	85°C	95°C	105°C	110°C																																			
MULTIPLIER	3.0	2.8	2.6	2.4	2.2	1.8	1.5	1.0	0.5																																			
CAPACITOR DIAMETER	51mm	63mm	76mm	90mm																																								
Maximum current	30A	40A	50A	70A																																								
Insulation Resistance	At 100V DC for 1 min is >100 MΩ across insulating sleeve and terminals.																																											
Vibration Resistance	Frequency range : 10 Hz to 55 Hz Capacitor length ≤ 143 : max acceleration 0.75mm or 10g for 3x2 h Capacitor length > 143 : max acceleration 0.35mm or 5g for 3x0.5 h																																											
Withstand voltage (between terminals bundled and plate)	2500 VAC for 1 min																																											
Life test (105°C, V_n, I_r applied)	After 2,000 hours application of rated voltage at 105°C capacitors meet characteristics aside	Cap change ≤ 10% tan δ ≤ 130% Leakage current (I _L) < initial limit Impedance (Z) ≤ 130%																																										
Shelf life	After leaving capacitors under no load for 500 hours at 105°C, when restored at 20°C meet specifications aside	Cap change ≤ ±15% tan δ ≤ 150% Leakage current (I _L) < initial limit																																										
Useful life (105°C, V_n, I_r applied)	> 8.000 h at 105°C																																											
Failure percentage Failure rate	≤ 1% (during useful life) ≤ 40 fit (40 10 ⁻⁹ /h)																																											
Self inductance	Approx. 20 nH																																											
Damp heat test (V_n applied, 2000 hours, 85% RH)	Stable electrical parameters in humidity ambient condition 85°C																																											
Electrolyte	All the capacitors of this series have self-extinguishing electrolyte in accordance with IEC EN 60695-11-10																																											
Reference standards	CECC 30.300 IEC 60384-4 LONG LIFE GRADE																																											

K92 TYPE STANDARD RATINGS

Cap µF	Ø x L mm	Tan δ MAX 100 Hz 20°C	ESR TYP mΩ 100 Hz 20°C	Z TYP mΩ 10 kHz 20°C	I _r a.c. A max 100 Hz 105°C	PART NUMBER stud and insert style excluded
470	51x79	0.08	139	112	3.45	K92400471_M0G079
680	51x79	0.08	107	100	3.90	K92400681_M0G079
1000	51x79	0.08	75	67	4.50	K92420102_M0G079
1000	51x105	0.08	75	67	4.90	K92400102_M0G105
1500	63x105	0.08	53	40	6.00	K92400152_M0H105
2200	63x105	0.08	40	31	7.50	K92400222_M0H105
2200	76x105	0.08	40	31	8.50	K92400222_M0J105
3300	76x143	0.08	25	16	11.30	K92400332_M0J143
4700	76x143	0.08	20	15	14.10	K92400472_M0J143
5600	76x143	0.08	17	11	14.30	K92400562_M0J143
6800	76x143	0.08	15	10	18.00	K92400682_M0J143
8200	76x214	0.08	14	10	20.10	K92400822_M0J214
10000	90x220	0.09	13	9	25.10	K92400103_M0L220

**RATED
VOLTAGE
VDC**

400V

Cap µF	Ø x L mm	Tan δ MAX 100 Hz 20°C	ESR TYP mΩ 100 Hz 20°C	Z TYP mΩ 10 kHz 20°C	I _r a.c. A max 100 Hz 105°C	PART NUMBER stud and insert style excluded
470	51x79	0.08	139	112	3.45	K92420471_M0G079
680	51x79	0.08	107	100	3.90	K92420681_M0G079
1000	51x79	0.08	75	67	4.50	K92420102_M0G079
1000	51x105	0.08	75	67	4.90	K92420102_M0G105
1500	63x105	0.08	53	40	6.00	K92420152_M0H105
2200	63x105	0.08	40	31	7.50	K92420222_M0H105
2200	76x105	0.08	40	31	8.50	K92420222_M0J105
3300	76x143	0.08	25	16	11.30	K92420332_M0J143
4700	76x143	0.08	20	15	14.10	K92420472_M0J143
5600	76x143	0.08	17	11	14.30	K92420562_M0J143
6800	76x143	0.08	15	10	18.00	K92420682_M0J143
8200	76x214	0.08	14	10	20.10	K92420822_M0J124
10000	90x220	0.09	13	9	25.10	K92420103_M0L220

**RATED
VOLTAGE
VDC**

420V

K92 TYPE STANDARD RATINGS

Cap µF	Ø x L mm	Tan δ MAX 100 Hz 20°C	ESR TYP mΩ 100 Hz 20°C	Z TYP mΩ 10 kHz 20°C	I _r a.c. A max 100 Hz 105°C	PART NUMBER stud and insert style excluded
470	51x79	0.08	159	120	3.20	K92450471__M0G079
680	51x105	0.08	114	105	4.40	K92450681__M0G105
1000	51x105	0.08	83	70	5.10	K92450102__M0G105
1000	63x105	0.08	83	70	5.40	K92450102__M0H105
1500	63x105	0.08	57	42	6.50	K92450152__M0H105
1500	76x105	0.08	57	42	7.20	K92450152__M0J105
2200	76x143	0.08	44	33	9.50	K92450222__M0J143
3300	76x143	0.08	30	18	12.30	K92450332__M0J143
4700	76x143	0.08	21	15	13.20	K92450472__M0J143
5600	76x143	0.08	18	12	14.10	K92450562__M0J143
6800	76x214	0.08	16	11	19.30	K92450682__M0J214
8200	76x214	0.08	15	11	20.10	K92450822__M0J214
10000	90x220	0.09	12	10	26.10	K92450103__M0L220

**RATED
VOLTAGE
VDC**

450V

Cap µF	Ø x L mm	Tan δ MAX 100 Hz 20°C	ESR TYP mΩ 100 Hz 20°C	Z TYP mΩ 10 kHz 20°C	I _r a.c. A max 100 Hz 105°C	PART NUMBER stud and insert style excluded
1500	51x105	0.12	59	44	5.1	K92500152__M0G105
2200	63x105	0.12	47	37	6.4	K92500222__M0H105
3300	76x105	0.12	33	22	9.0	K92500332__M0J105
4700	76x143	0.12	22	16	12.0	K92500472__M0J143
5600	76x143	0.12	20	14	12.4	K92500562__M0J143
6800	76x214	0.12	17	12	17.3	K92500682__M0J214
8200	76x214	0.12	16	11	20.1	K92500822__M0J214
10000	90x220	0.12	13	10	21.2	K92500103__M0L220

**RATED
VOLTAGE
VDC**

500V

PLEASE TO CONTACT OUR TECHNICAL SERVICE FOR MORE INFORMATION OR SPEC-IN ANALYSIS.