

Ver.	Modify No.	Details	Area	P.I.C	Date

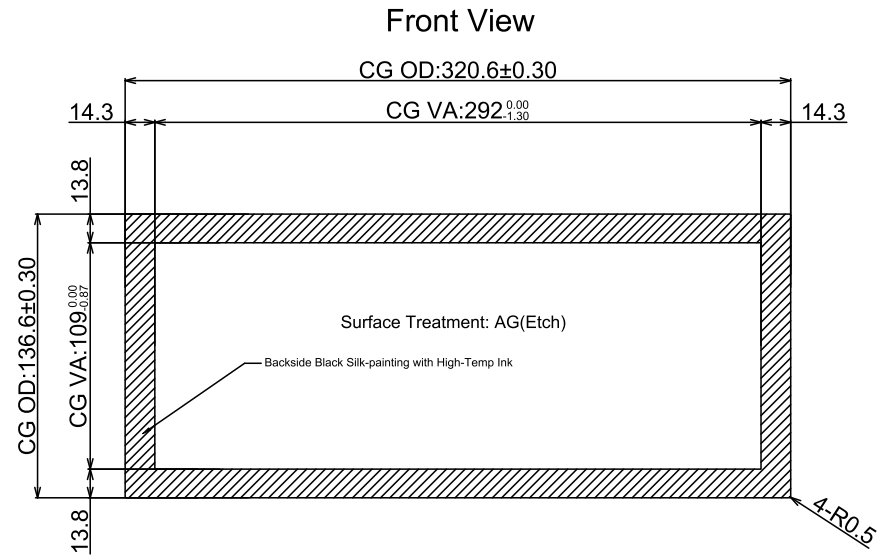

Side View

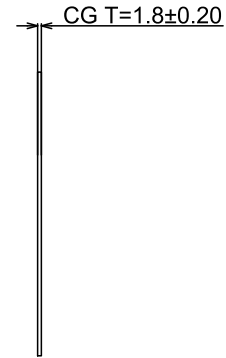

Technical Datasheet:

1. Cover Glass: T=1.8mm, Surface hardness ≥6H
2. Light transmittance: ≥82%
3. Working Temperature: -20℃~+70℃, ≤85%RH;
4. Storage Temperature: -30℃~+80℃, ≤85%RH;
5. Unmarked Tolerance: ± 0.3 mm;
6. All material used conform to RoHS standards

Part No.		BTP-CG-12.3-AG-R01		
Product Name:		Drawing No.	C123230523R01	
12.3 inch Cover Glass		Project Code.	C123R01	
Business Unit:		Period Mark	View Angle	Ratio
SNT-BTP		A		1:1
Designed by:	Curry.Wang	BOM Code		1.10.123.01.0101
Checked by:	Betty.Fu	Page 1		Total 1 Page
Approved by:	Cale.Chen	Product Series	BTP-CG	
Workmanship:		思诺泰科创电子(苏州)有限公司 SINOTRONICS INC.		
Standardization:	Link.Chen			
Released by:	Rocky.Liu			