

Ver.	Modify No.	Details	Area	P.I.C	Date

FRONT VIEW

SIDE VIEW

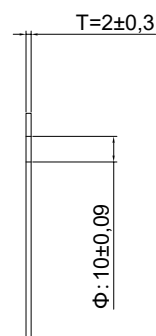
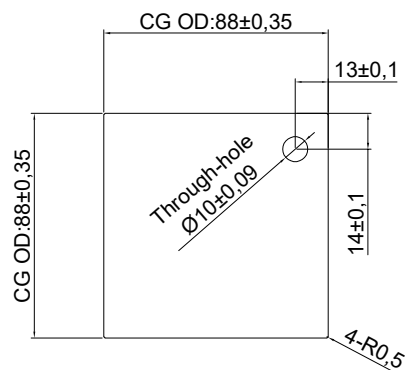

Technical Datasheet:

1. Cover Glass: T=2mm, Tempered glass,
2. Surface hardness: ≥6H
3. Light transmittance: ≥90%
4. Working Temperature: -20°C~+80°C, ≤85%RH;
5. Storage Temperature: -30°C~+80°C, ≤85%RH;
6. Unmarked Tolerance: ± 0.3 mm;
7. All material used conform to RoHS standards

Part No.	BTP-CG-4.9-CLN-SN01			
Product Name: 4.9 inch Cover Glass	Drawing No.	C049250301SN01		
	Project Code.	C049SN01		
Business Unit: SNT-BTP	Period Mark	View Angle	Ratio	
	A		1:1	
Workmanship:	BOM Code	Page 1	Total 1 Page	
Standardization:	Product Series	BTP-CG		思诺泰科创电子（苏州）有限公司 SINOTECHNICS INC.
Released by:	Rocky.Liu			

Designed by:	Curry.Wang
Checked by:	Betty.Fu
Approved by:	Cale.Chen
Workmanship:	
Standardization:	Link.Chen
Released by:	Rocky.Liu